

SW105KIWAYU

PEGASO S.r.l.

CHARTER



SW105 Kiwayu (formerly Wolfhound) is a modern sailing superyacht that seamlessly combines advanced design, technology, and performance. Perfectly suited for both families and sailing enthusiasts, she offers an exhilarating yet comfortable experience, all while maintaining the highest standards of 5-star service. With her spacious, light-filled interiors and high-performance sailing capabilities, Kiwayu provides an unforgettable charter experience for up to 8 guests, showcasing the very best in modern luxury yachting. Managed by an expert crew, she sets the bar for contemporary sailing yachts.

Since her birth, this yacht was carefully maintained by a high professional crew and she stands out like a brand-new yacht.

SW105
KIWAYU



SW105
KIWAYU

The modern design of Kiwayu emerges strongly on the single level deck which provides comfortable and safe passages from the aft to the forward guest cockpit.

Her Raised Saloon configuration allows light to flood into the interior through panoramic windows, hull portlights and a doublewide electrically operated companionway.



Kiwayu features generously wide aft sections and an open transom that ensures an ample deck area and abundant interior volumes, elements that are a real plus for any performance cruiser.

Her telescopic keel guarantees access to shallower harbors and bays and excellent stability and sail carrying capability, without compromising the interior layout.



The ample and protected guest cockpit, with dining and sunbathing areas, is well separate from the aft crew cockpit that concentrates most of the maneuvering gear. This area is an ideal maneuvering space with independent, direct access to crew quarters without passing through the guests area. A dodger, bimini with removable side panels and a boom-extended awning, allow maximum flexibility for protecting and shading the guests cockpit and the sunbathing area.





SW105 KIWAYU

Kiwayu stands out for a range of features that make her the ideal yacht for comfortable cruising. The fully equipped guest cockpit has a coffee table with a cool box and two deck fridges.

Kiwayu's tender garage accommodates a Williams Sport Jet 435 tender plus storage space for toys and equipment, an exceptional feature for a yacht this size. Hydraulically retractable carbon gangway makes for easy boarding from the quay.

A custom electric dumbwaiter from the galley to the cockpit makes for efficient serving and clearing.



Kiwayu's interior features a four-cabin interior arrangement with master cabin forward, VIP guest cabin forward and TV lounge area forward of the saloon and two additional guest cabins with twin beds are located aft of the saloon.

Crew quarters, galley and nav station are in the aftermost section of the interior, allowing maximum privacy for guests and crew.





SW105
KIWAYU



The main saloon is a light, bright open space where eight to ten people can relax and converse in comfort on couches or at the dining table.

Immediately fore of the living area an ample studio/TV area flawlessly separates the main saloon from the owner's private area.



The master cabin, in the quietest area of the yacht, has a wide and comfortable bed, handy shelves and drawers, a comfortable sofa and a well-lit en suite. The same attention to privacy, luxury, comfort and details that are used in the master cabin are found throughout the entire yacht.



SW105
KIWAYU

A VIP cabin forward of the saloon features a queen-sized bed. Two more twin guest cabins are located aft of the saloon. All guest cabins are en suite for privacy and functionality. Guests can also enjoy a highly sophisticated and integrated entertainment system with AMX controller.



The crew area aft is an efficient living and working environment for five to six and includes three cabins and two heads. Galley, mess area and nav station layout have been studied carefully to favour the movement of crew about their various tasks.

The area is served by a dedicated companionway to ensure the privacy of owners and their guests.



An aerial photograph of a sailboat, the SW105 Kiwayu, sailing on a deep blue ocean. The boat is viewed from a high angle, showing its white sails, wooden deck, and cabin. The name 'KIWAYU' is visible on the stern. The boat is moving towards the top right, leaving a white wake behind it.

SW105
KIWAYU

KEY FEATURES

- Sporty and elegant
- Full carbon construction
- Fast and fun
- Comfort and privacy
- Telescopic Keel
- New North Sails sails wardrobe (2025)
- New hull painting (2022)
- Multinational and experienced crew of five

LAYOUT

8 guests in 4 cabins
5 crew in 3 cabins



SW105
KIWAYU

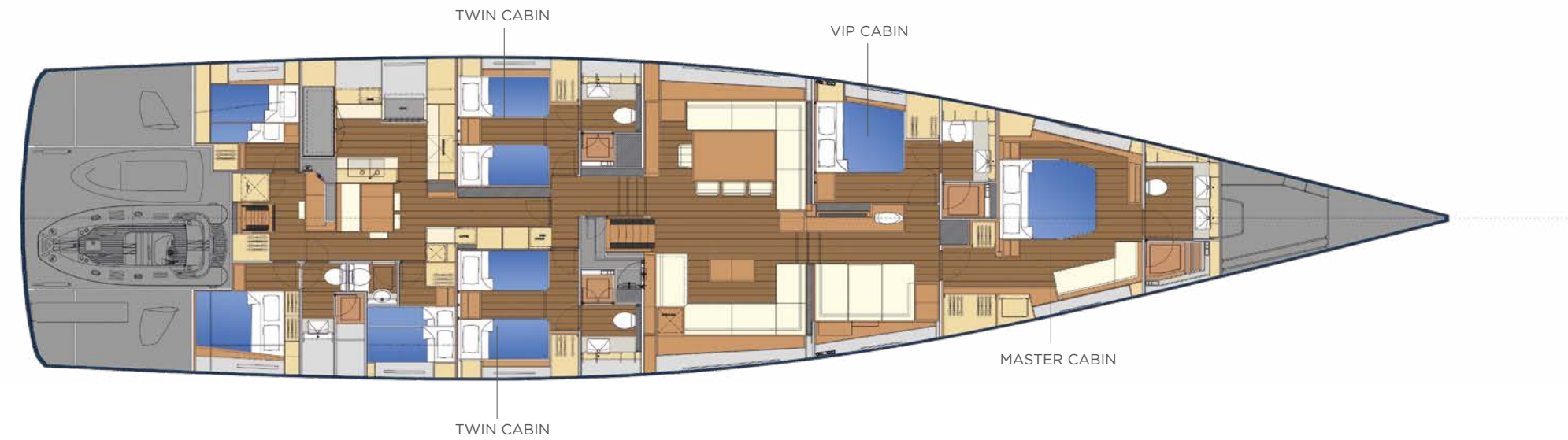

SPECS

Year of construction: 2018
Flag: Malta

MAIN DATA

- LOA: 34,59m (113ft)
[32,27m (105ft) Excluding bowsprit]
- LWL: 29,44m (96,58ft)
- BEAM (MAX): 7,31 m (24ft)
- DRAFT: 3,65 m–5,6 m (12-18ft) [Telescopic keel]
- DISPLACEMENT: 69.500Kg (153,221Lbs) [Lightship IRC]
- ENGINE: Cummins QSB 6,7 MCD (305 hp @2,600 rpm)

DESIGNERS

- NAVAL ARCHITECT: Farr Yacht Design
- GENERAL CONCEPT: Nauta Design and Southern Wind Shipyard with Farr Yacht Design
- DECK AND INTERIOR DESIGN: Nauta Design

TENDER & TOYS

- Williams Sport Jet 435 tender (December 2023)
- Sea bob
- (2x) Paddleboards
- Water Skis
- Wakeboard
- Donut Tube
- Snorkelling Equipment

Disclaimer
The Company offers the details of this vessel in good faith but cannot guarantee or warrant the accuracy of this information nor warrant the condition of the vessel. A buyer should instruct his agents, or his surveyors, to investigate such details as the buyer desire validated. This vessel is offered subject to prior sale, price change, or withdrawal without notice. This specification/inventory will only form part of the contract when attached to a sales contract that has been signed and agreed by both seller and buyer.



SW105 KIWAYU

PEGASO S.r.l.

Salita Dinegro 7/1, 16123
Genova, Italy

Ph. +39 010 570 4035
charter@pegasoyd.com